

# Acoples Hidráulicos

---

**VE**  **SI**  
*Guatemala*



**NF/NM**

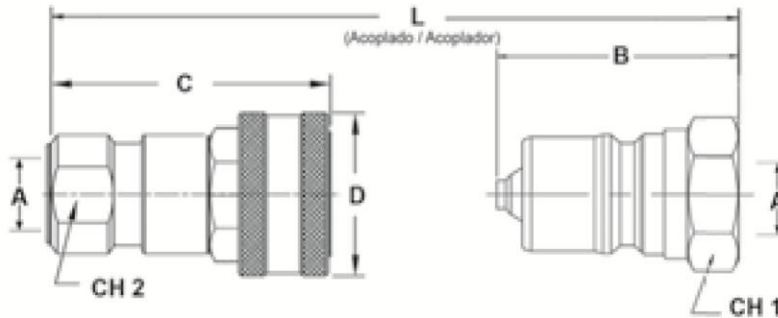

**VÁLVULA - SERIE 4000**  
Coupler - 4000 Series

| Código<br>Code | Medida<br>Size | Presión<br>Pressure |        | Caudal<br>Flow | Temperatura<br>Temperature | Material                 |
|----------------|----------------|---------------------|--------|----------------|----------------------------|--------------------------|
|                |                | PSI                 | BAR    |                |                            |                          |
| NF40-04        | 1/4"           | 5000                | 344.74 | 3              | -20 °C + 100 °C            | Buna-N (Nitrilo/Nitrile) |
| NF40-06        | 3/8"           | 4000                | 275.79 | 6              | -20 °C + 100 °C            | Buna-N (Nitrilo/Nitrile) |
| NF40-08        | 1/2"           | 4000                | 275.79 | 12             | -20 °C + 100 °C            | Buna-N (Nitrilo/Nitrile) |
| NF40-12        | 3/4"           | 3000                | 206.84 | 28             | -20 °C + 100 °C            | Buna-N (Nitrilo/Nitrile) |
| NF40-16        | 1"             | 3000                | 206.84 | 50             | -20 °C + 100 °C            | Buna-N (Nitrilo/Nitrile) |

**ACOPLE - SERIE 4000**  
Nipple- 4000 Series

| Código<br>Code | Medida<br>Size | Presión<br>Pressure |        | Caudal<br>Flow | Temperatura<br>Temperature | Material                 |
|----------------|----------------|---------------------|--------|----------------|----------------------------|--------------------------|
|                |                | PSI                 | BAR    |                |                            |                          |
| NM40-04        | 1/4"           | 5000                | 344.74 | 3              | -20 °C + 100 °C            | Buna-N (Nitrilo/Nitrile) |
| NM40-06        | 3/8"           | 4000                | 275.79 | 6              | -20 °C + 100 °C            | Buna-N (Nitrilo/Nitrile) |
| NM40-08        | 1/2"           | 4000                | 275.79 | 12             | -20 °C + 100 °C            | Buna-N (Nitrilo/Nitrile) |
| NM40-12        | 3/4"           | 3000                | 206.84 | 28             | -20 °C + 100 °C            | Buna-N (Nitrilo/Nitrile) |
| NM40-16        | 1"             | 3000                | 206.84 | 50             | -20 °C + 100 °C            | Buna-N (Nitrilo/Nitrile) |

**D**

Acoples Hidráulicos  
Hydraulics Couplers

**BF/BM**

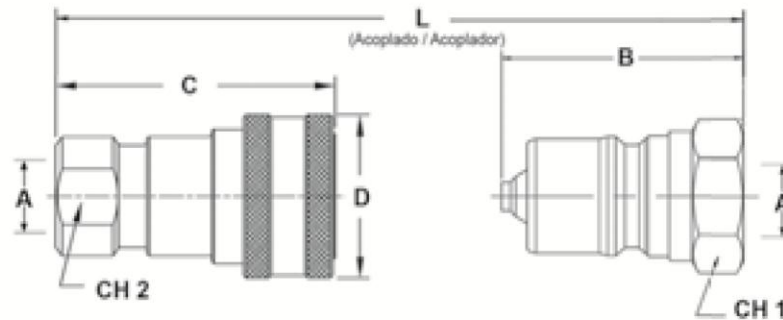

**VÁLVULA - SERIE 60**

*Coupler - 60 Series*

| Código<br>Code | Medida<br>Size | Presión<br>Pressure |        | Caudal<br>Flow | Temperatura<br>Temperature | Material                 |
|----------------|----------------|---------------------|--------|----------------|----------------------------|--------------------------|
|                |                | PSI                 | BAR    |                |                            |                          |
|                | in             |                     |        | GPM            | °C                         |                          |
| BF60-04        | 1/4"           | 5000                | 344.74 | 3              | -20 °C + 100 °C            | Buna-N (Nitrilo/Nitrile) |
| BF60-06        | 3/8"           | 4000                | 275.79 | 6              | -20 °C + 100 °C            | Buna-N (Nitrilo/Nitrile) |
| BF60-08        | 1/2"           | 4000                | 275.79 | 12             | -20 °C + 100 °C            | Buna-N (Nitrilo/Nitrile) |
| BF60-12        | 3/4"           | 3000                | 206.84 | 28             | -20 °C + 100 °C            | Buna-N (Nitrilo/Nitrile) |
| BF60-16        | 1"             | 3000                | 206.84 | 50             | -20 °C + 100 °C            | Buna-N (Nitrilo/Nitrile) |

**ACOPLE - SERIE 60**

*Nipple - 60 Series*

| Código<br>Code | Medida<br>Size | Presión<br>Pressure |        | Caudal<br>Flow | Temperatura<br>Temperature | Material                 |
|----------------|----------------|---------------------|--------|----------------|----------------------------|--------------------------|
|                |                | PSI                 | BAR    |                |                            |                          |
|                | in             |                     |        | GPM            | °C                         |                          |
| BM60-04        | 1/4"           | 5000                | 344.74 | 3              | -20 °C + 100 °C            | Buna-N (Nitrilo/Nitrile) |
| BM60-06        | 3/8"           | 4000                | 275.79 | 6              | -20 °C + 100 °C            | Buna-N (Nitrilo/Nitrile) |
| BM60-08        | 1/2"           | 4000                | 275.79 | 12             | -20 °C + 100 °C            | Buna-N (Nitrilo/Nitrile) |
| BM60-12        | 3/4"           | 3000                | 206.84 | 28             | -20 °C + 100 °C            | Buna-N (Nitrilo/Nitrile) |
| BM60-16        | 1"             | 3000                | 206.84 | 50             | -20 °C + 100 °C            | Buna-N (Nitrilo/Nitrile) |

**D**

Acoples Hidráulicos  
Hydraulics Couplers

**AF/AM**

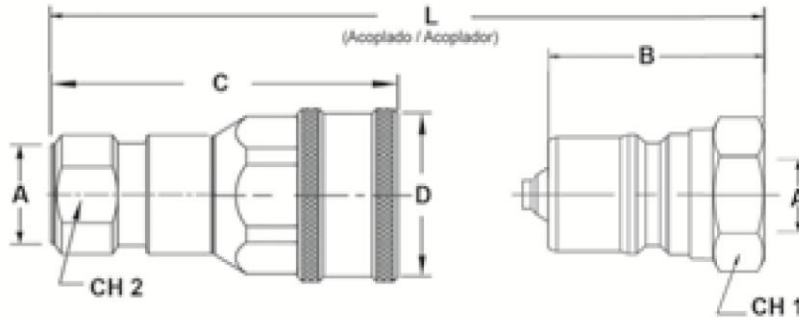

**VÁLVULA - SERIE 6600**  
*Coupler- 6600 Series*

| Código<br>Code | Medida<br>Size | Presión<br>Pressure |        | Caudal<br>Flow | Temperatura<br>Temperature | Material                 |
|----------------|----------------|---------------------|--------|----------------|----------------------------|--------------------------|
|                |                | PSI                 | BAR    |                |                            |                          |
| AF66-04        | 1/4"           | 5000                | 344.74 | 3              | -20 °C + 100 °C            | Buna-N (Nitrilo/Nitrile) |
| AF66-06        | 3/8"           | 4000                | 275.79 | 6              | -20 °C + 100 °C            | Buna-N (Nitrilo/Nitrile) |
| AF66-08        | 1/2"           | 4000                | 275.79 | 12             | -20 °C + 100 °C            | Buna-N (Nitrilo/Nitrile) |
| AF66-12        | 3/4"           | 3000                | 206.84 | 28             | -20 °C + 100 °C            | Buna-N (Nitrilo/Nitrile) |
| AF66-16        | 1"             | 3000                | 206.84 | 50             | -20 °C + 100 °C            | Buna-N (Nitrilo/Nitrile) |

**ACOPLE - SERIE 6600**  
*Nipple - 6600 Series*

| Código<br>Code | Medida<br>Size | Presión<br>Pressure |        | Caudal<br>Flow | Temperatura<br>Temperature | Material                 |
|----------------|----------------|---------------------|--------|----------------|----------------------------|--------------------------|
|                |                | PSI                 | BAR    |                |                            |                          |
| AM66-04        | 1/4"           | 5000                | 344.74 | 3              | -20 °C + 100 °C            | Buna-N (Nitrilo/Nitrile) |
| AM66-06        | 3/8"           | 4000                | 275.79 | 6              | -20 °C + 100 °C            | Buna-N (Nitrilo/Nitrile) |
| AM66-08        | 1/2"           | 4000                | 275.79 | 12             | -20 °C + 100 °C            | Buna-N (Nitrilo/Nitrile) |
| AM66-12        | 3/4"           | 3000                | 206.84 | 28             | -20 °C + 100 °C            | Buna-N (Nitrilo/Nitrile) |
| AM66-16        | 1"             | 3000                | 206.84 | 50             | -20 °C + 100 °C            | Buna-N (Nitrilo/Nitrile) |

**ESET61**

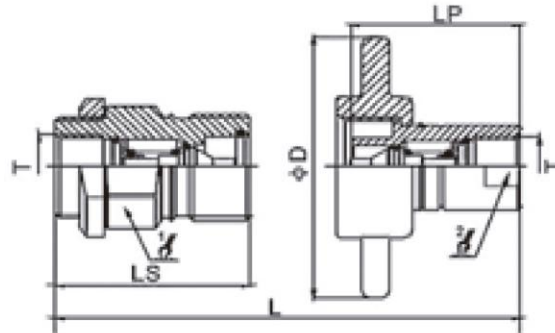

**JUEGO DE ACOPLES PARA USO GENERAL - SERIE 6100**

*General Use Couplers Set - 6100 Series*

| Código<br>Code | Medida<br>Size | Presión<br>Pressure |        | Caudal<br>Flow | Temperatura<br>Temperature | Material<br>Material     |
|----------------|----------------|---------------------|--------|----------------|----------------------------|--------------------------|
|                |                | PSI                 | BAR    |                |                            |                          |
| ESET61-16      | 1"             | 3000                | 206.84 | 50             | -20 °C + 100 °C            | Buna-N (Nitrilo/Nitrile) |

**D**

Acoples Hidráulicos  
Hydraulics Couplers

**www.veysi.com.gt**  
**ventas@veysi.com.gt**  
**ventasveysi@gmail.com**

**PBX: 502 7889 3484**

**Móvil: 502 5634 3880 - 502 5531 0088**

---

**VEYSI**

**HORARIO DE ATENCIÓN**

**Lunes a Viernes de 7:30 am a 6:00 pm**

**Sábados de 7:30 am a 4:00 pm**

**Domingos, días y horarios no hábiles se cubren  
emergencias**